

**structural transformations**

**column**

**force systems**

**beam**

**materials**

**truss**

**transformations**

**arch**

**vault**

**dome**

**shell**

**plate**

**structural transformations**

**equilibrium**

**geometry/load transfer potential**

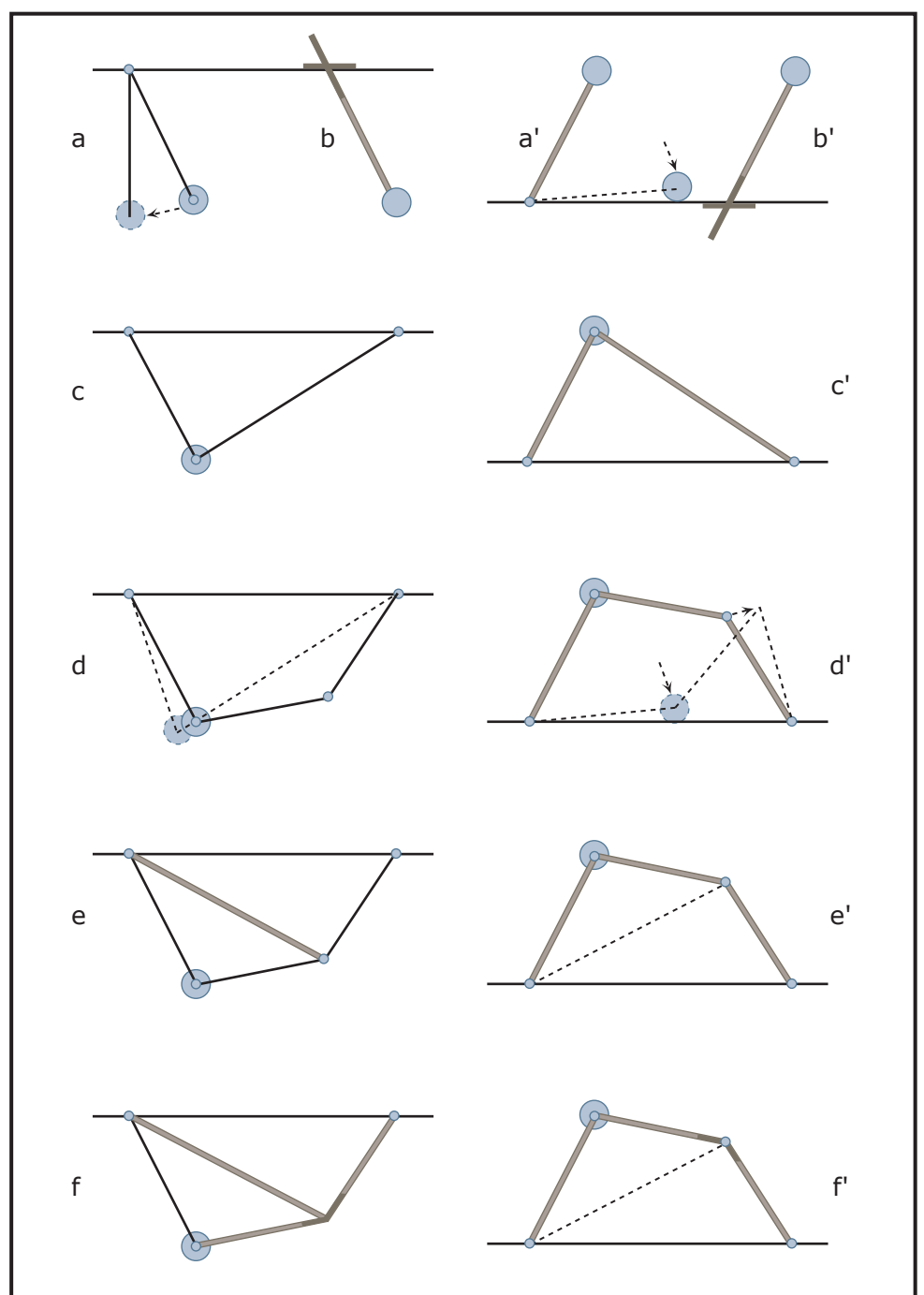

Images by MIT OCW.

# structural transformations

column

beam

truss

arch

vault

dome

shell

plate

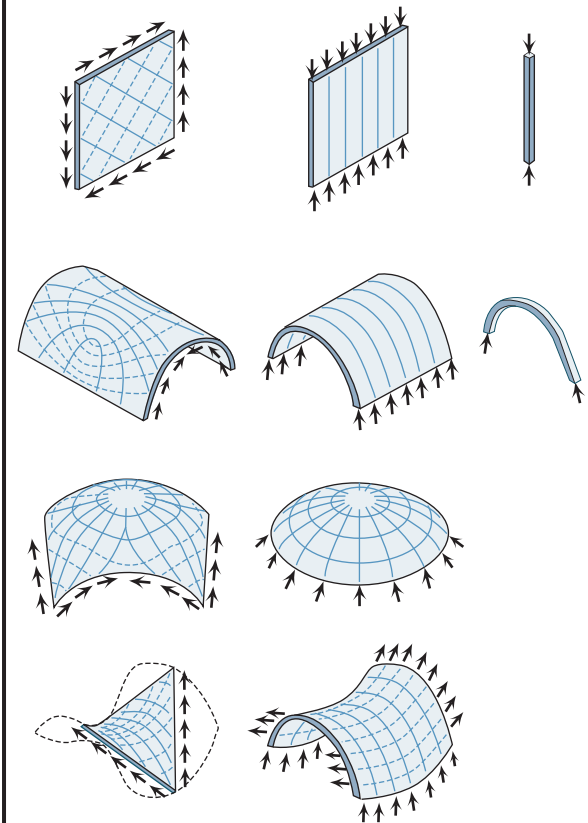
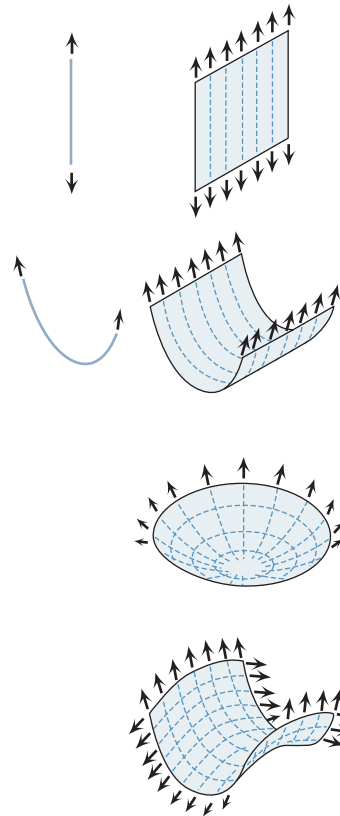
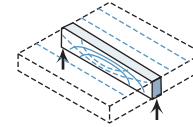
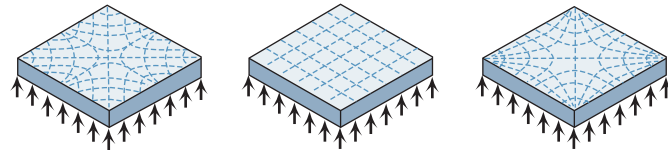

# structural transformations

column

beam

truss

arch

vault

dome

shell

plate

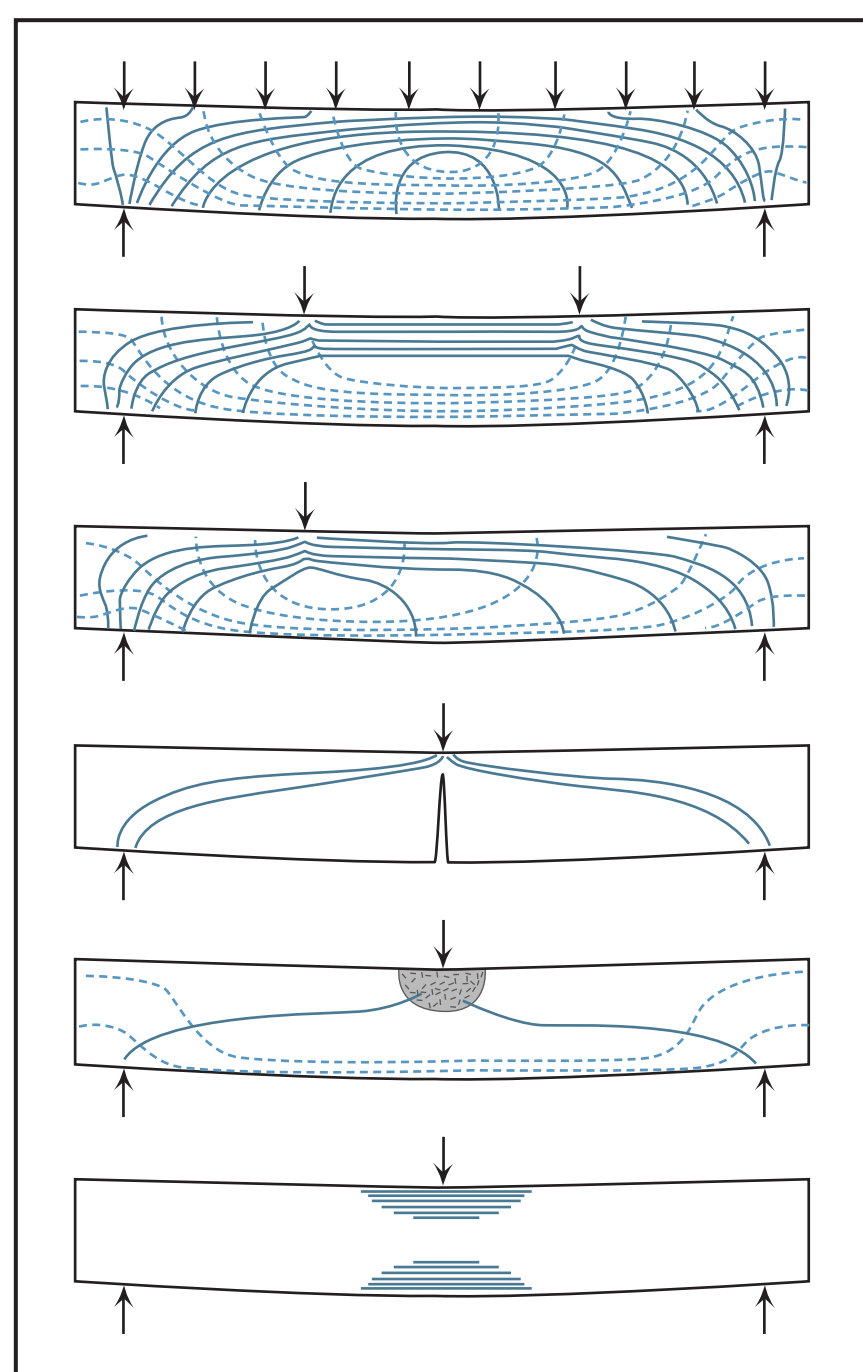
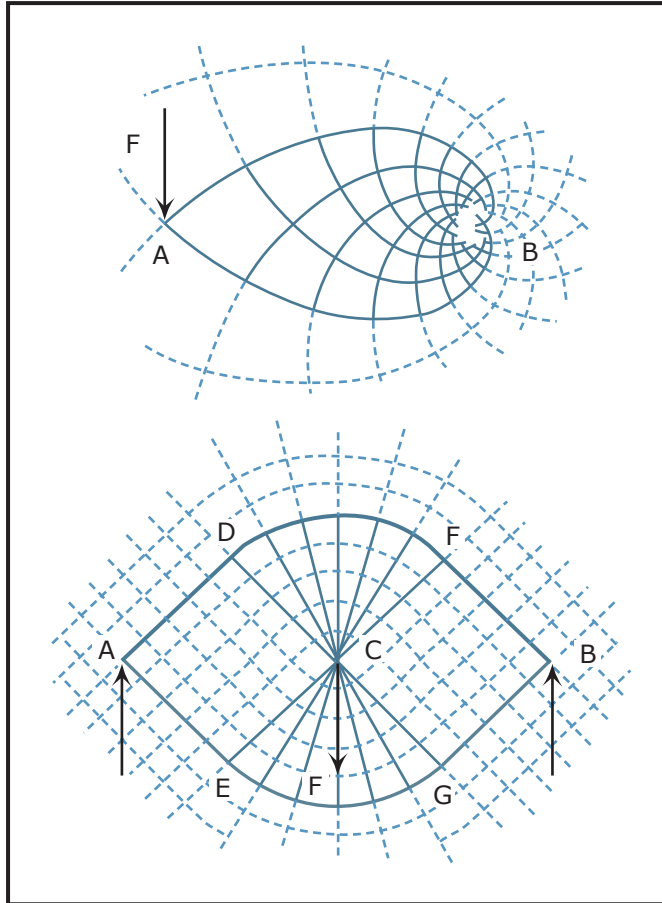

# structural transformations

column

beam

**truss**

arch

vault

dome

shell

plate

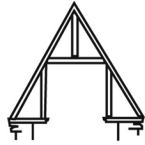
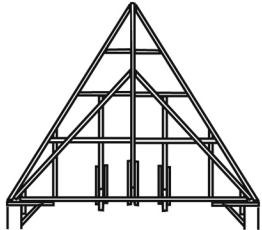
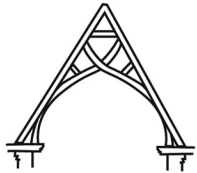
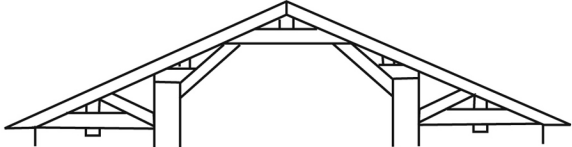
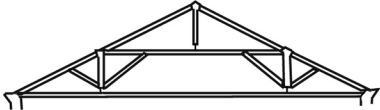
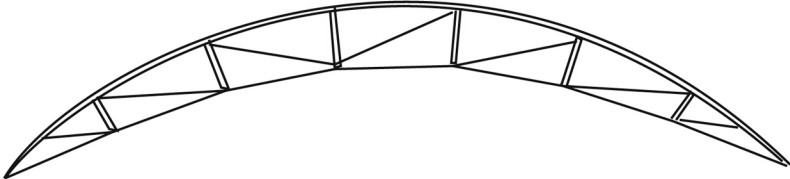

Image by MIT OCW.

# structural transformations

column

beam

truss

arch

vault

dome

shell

plate

